

**Proposed Layout for 6th IISF
Hall No 12, Pragati Maidan, Delhi
16-17-18, October 2018
OPTION - 6**

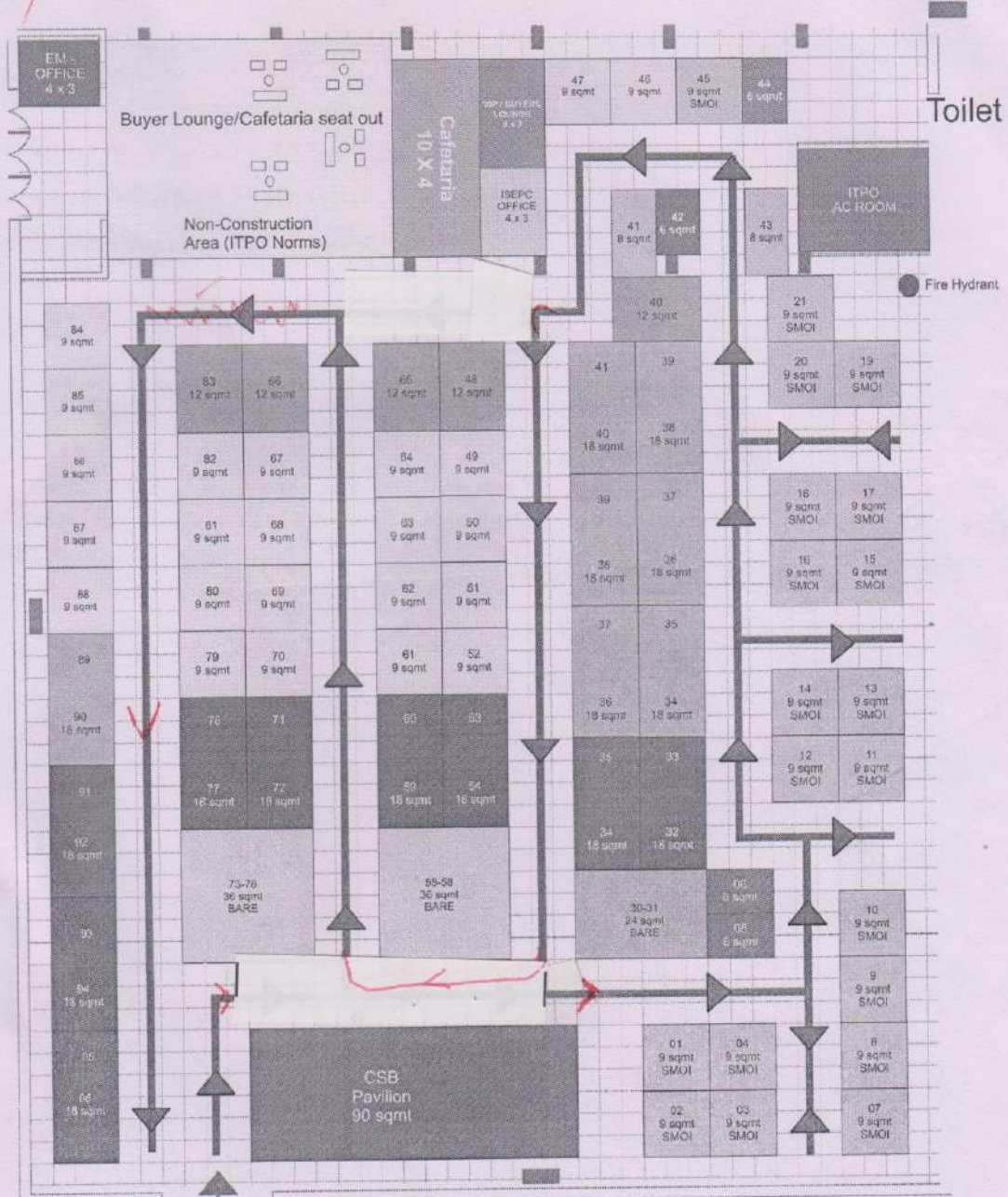

Index	
a. CSB Pavilion	- 90 sqm - 01-Bare Space
b. SMOI Stalls	- 09 sqm - 20
c. Stalls	- 06 sqm - 04
d. Stall	- 08 sqm - 02
e. Stalls	- 09 sqm - 23
f. Stalls	- 12 sqm - 06
g. Stalls	- 18 sqm - 09+07
h. Stalls	- 24 sqm - 01-Bare Space
i. Stalls	- 36 sqm - 02-Bare Space

No of Stalls = 96	Movement Direction
Cafeteria = 40 sqm	
Non-Construction Area = 180 sqm	
ISEPC Office = 12 sqm	
VIP / BUYER Lounge = 15 sqm	
Event Manager Office = 09 sqm	



Total Performance
 EXHIBITIONS • FASHION SHOWS • THEME DECOR
 CONFERENCES • EVENT DESIGNING • CELEBRITY MANAGEMENT

Prepare by : Hi Secure Exhibition Services Pvt. Ltd.